

MADE IN ITALY

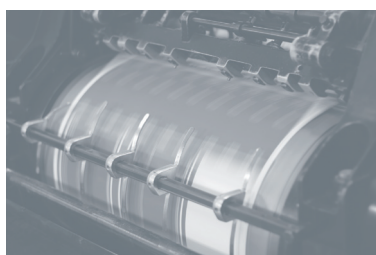

INDUSTRIAL range



MiniCUBE

The smallest silent screw compressor



Fixed speed
2.2 kW



NEW

MINI CUBE

SILENT ROTARY SCREW COMPRESSOR

MADE IN ITALY

All the power of a screw compressor in one cubic meter

Shock-resistant, thermoformed protective cover

Intake regulator

Oil filter

Separator block

Air-end

Oil separator tank

Oil drain

Optional heater: prevents the formation of condensate, maintaining an adequate oil temperature during the standby phase of the compressor.

LOGIN ZERO controller

Radial fan

Electric cabin

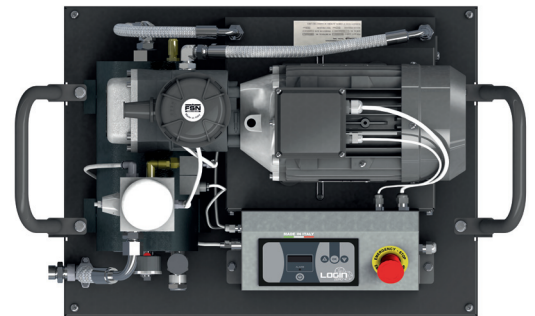

Air filter

Electric motor

Emergency button

Heat exchanger

Oil level display

Heater arrangement

(as optional)

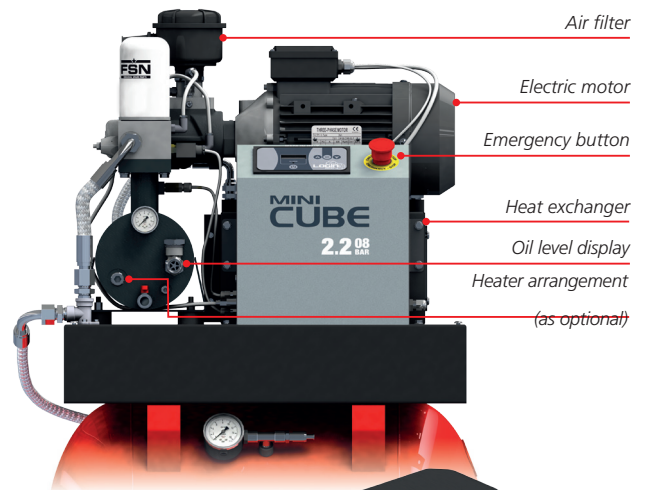

1060 mm

less than 1m³

NEW



LOGIN ZERO

Multi-function controller with 5-digit LED display

Measures and displays:

- ▶ Compressor status (stand-by, idle, loaded, off).
- ▶ Operating temperature.
- ▶ Operating pressure.
- ▶ Total working hours and load hours.
- ▶ Remaining hours for maintenance.

- ▶ Alarm management (motor thermal overload, fan thermal overload, oil temperature values) with dedicated LED signalling.
- ▶ Auto-restart after power failure.
- ▶ Integrated digital phase sequence control.



MAXI Performance MINI Dimensions.

only 65 dB(A)



2.2 kW



8 - 10 Bar



with continuous cycle



Reliable, compact, silent

MiniCUBE is the new oil-lubricated coaxial compressor with direct starter, the smallest of the entire FINI screw range. The small size of the air-end/motor connection system allows the machine to maintain an extremely small footprint. Furthermore, thanks to its extreme quietness, only 65 dB(A), it can be placed near any operating environment. MiniCUBE is available in the floor mounted version or on a painted or galvanized 90-litre tank.

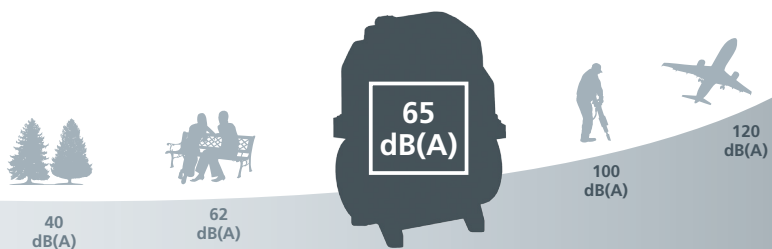

Efficient and cost-effective

MiniCUBE is designed for continuous operation in industrial applications. The coaxial transmission, with the air-end directly connected to the electric motor without any flexible coupling, ensures the best transmission efficiency. The three-phase versions are equipped with an IE3 energy efficiency class motor. The FS14 air-end ensures minimum pressure losses, providing considerable energy savings and low operating and maintenance costs.

Easy to transport

MiniCUBE is handy and easy to move, thanks to the 2 sides handles (only floor mounted version) and the forklift or pallet truck pre-arrangement at the bottom of the tank.

Simplified maintenance

All internal components are easily accessible, making routine maintenance fast and simple to perform.

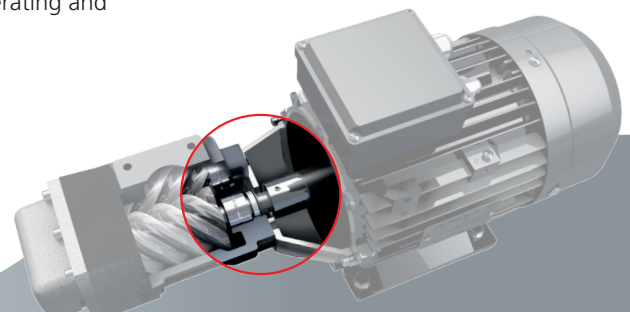

PLUG&PLAY
MiniCUBE is ready for use: it is supplied already equipped with RotarECOFLUID mineral oil.

	Model	Code	ℓ	Power supply		Air outflow rate			MAX		dB(A)	BSP	kg	L x W x H (mm)			kg	L x W x H (mm)		
				kW	HP	V/Ph/Hz	l/min.	m³/min.	c.f.m.	bar				psi	L	W		H	L	W
FLOOR MOUNTED	MiniCUBE 2.2-08	V51PC72FNM017	-	2.2	3	400/3/50	292	0.29	10.3	8	116	65	1/2"	68	780x460x600	79	840x540x790			
	MiniCUBE 2.2-08 M	V51PC60FNM017	-	2.2	3	230/1/50	292	0.29	10.3	8	116	65	1/2"	68	780x460x600	79	840x540x790			
	MiniCUBE 2.2-10	V51PK72FNM017	-	2.2	3	400/3/50	261	0.26	9.2	10	145	65	1/2"	68	780x460x600	79	840x540x790			
	MiniCUBE 2.2-10 M	V51PK60FNM017	-	2.2	3	230/1/50	261	0.26	9.2	10	145	65	1/2"	68	780x460x600	79	840x540x790			
PAINTED TANK	MiniCUBE 2.2-08-90	V72PC72FNM001	90	2.2	3	400/3/50	292	0.29	10.3	8	116	65	1/2"	104	730x460x1060	116	840x540x1340			
	MiniCUBE 2.2-08-90 M	V72PC60FNM001	90	2.2	3	230/1/50	292	0.29	10.3	8	116	65	1/2"	104	730x460x1060	116	840x540x1340			
	MiniCUBE 2.2-10-90	V72PK72FNM001	90	2.2	3	400/3/50	261	0.26	9.2	10	145	65	1/2"	104	730x460x1060	116	840x540x1340			
	MiniCUBE 2.2-10-90 M	V72PK60FNM001	90	2.2	3	230/1/50	261	0.26	9.2	10	145	65	1/2"	104	730x460x1060	116	840x540x1340			
GALVANIZED TANK	MiniCUBE 2.2-08-90 Z	V72PC72FNMZ01	90	2.2	3	400/3/50	292	0.29	10.3	8	116	65	1/2"	104	730x460x1060	116	840x540x1340			
	MiniCUBE 2.2-08-90 M Z	V72PC60FNMZ01	90	2.2	3	230/1/50	292	0.29	10.3	8	116	65	1/2"	104	730x460x1060	116	840x540x1340			
	MiniCUBE 2.2-10-90 Z	V72PK72FNMZ01	90	2.2	3	400/3/50	261	0.26	9.2	10	145	65	1/2"	104	730x460x1060	116	840x540x1340			
	MiniCUBE 2.2-10-90 M Z	V72PK60FNMZ01	90	2.2	3	230/1/50	261	0.26	9.2	10	145	65	1/2"	104	730x460x1060	116	840x540x1340			

M = Single-phase
Z = Galvanized tank

Reference conditions: air intake temperature 20°C (68°F) – atmospheric pressure 1 bar (14.5 p.s.i.).
Air flow was measured in the following operative pressures: 7.5 bar for models at 8 bar - 9.5 bar for models at 10 bar.
The data and results were measured in accordance with standard ISO 1217. The sound level was measured in accordance with standard ISO 3744.



A wide range of solutions for industrial applications



MICRO - PLUS
Oil-injected rotary screw compressors, with belt transmission, at fixed or variable speed, and power values from 2.2 to 75 kW.



K-MAX
Oil-injected rotary screw compressors, with direct transmission with or without gears, at fixed or variable speed, and power values from 5.5 to 90 kW.



TERA
Oil-injected rotary screw compressors, with direct driven, at fixed or variable speed, and power values from 110 to 250 kW.



OS Scroll
Oil-free compressors with scroll spiral pumps, at fixed speed, and power values from 2.2 to 30 kW.



AIR TREATMENT
Dryers, filters, vertical tanks, and a wide range of accessories for compressed air treatment.



FNA S.p.A.

Registered office and production plant: Via Einaudi, 6 - 10070 Robassomero (TO) - ITALY

Production plant: Via Toscana, 21 - 40069 Zola Predosa (BO) - ITALY

Foreign sales office: Tel. +39 011 9233000 - Fax: +39 011 9241138

www.finicompressors.com - info@fnacompressors.com

